

1504939

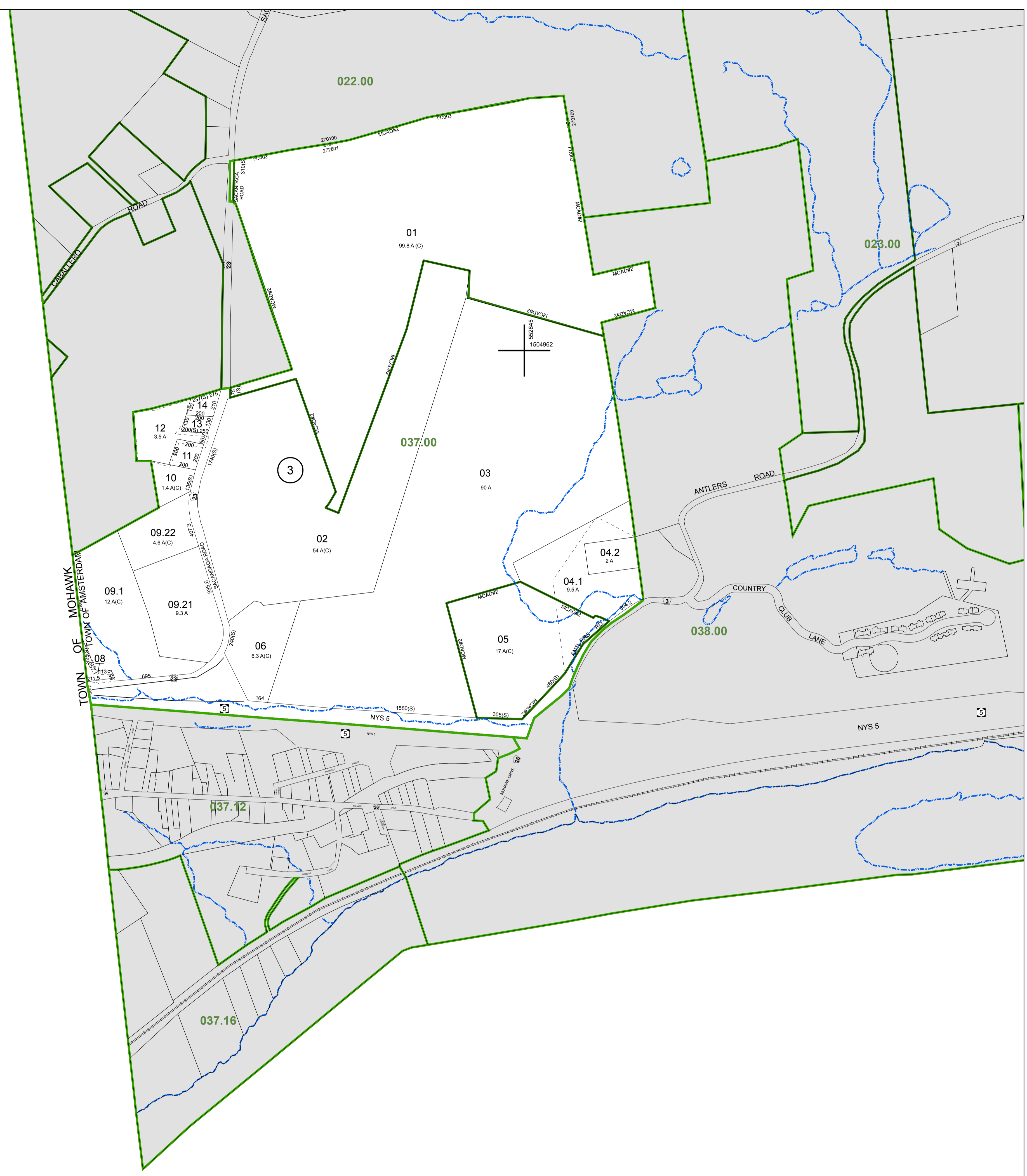

1504939



MAP PREPARED BY:
MONTGOMERY COUNTY
 Real Property Tax Service Agency
 Christine DePasquale, Director

Revision Table					
Date	Made by	Changes Made	Date	Made by	Changes Made
6/3/2022	HR	2023 UPDATES	1/29/2018	CD	2018 UPDATES
3/24/2021	HR	2022 UPDATES	1/9/2018	CD	2018 UPDATES
10/6/2019	HR	2020 UPDATES	10/18/2016	CD	2017 UPDATES
1/7/2019	CD	2019 UPDATES	5/13/2016	CD	2017 UPDATES
10/11/2018	CD	2019 UPDATES			

SPECIAL DISTRICTS	
FRZ: FD003	Tribes Hill Fire
AG: MCAD2	Montg co agri dist 2
LIGHT: LD001	Tribes Hill Light
SCHOOLS: 270100	Greater Amsterdam
272801	Fonds-Pultonville

PROPERTY LINE		PUBLIC RIGHT OF WAY	
ORIGINAL LOT LINE	---	PRIVATE RIGHT OF WAY	---
DENOTES COMMON OWNER	7	TOWN VILLAGE CITY	---
BLOCK LIMIT	---	RAILROAD	---
SECTION LINE	---	HYDROLOGY	---

LEGEND	
SCHOOL DISTRICT LINE	---
FIRE DISTRICT	---
AGRICULTURAL DISTRICT	---
MONUMENT LOCATOR	+
COORDINATE LOCATOR	+
DEED ACRES	7.5 A (c)
DEED ACRES	7.5 A
SCALED DIMENSION	22.5 (s)
DEED DIMENSION	150
TAX MAP BLOCK NUMBER	2

SHEET INDEX	
022.00	023.00
037.00	038.00

SECT NO 037.00
 These maps are intended for tax administration only, and not for the conveyance of property.
 Map Date: Mar 10, 2023

TAX MAP
TOWN OF AMSTERDAM
 MONTGOMERY COUNTY, NEW YORK
 1 inch = 400 feet
 0 100 200 400 600 800 Feet